

## ◆ 选型 Type Selection

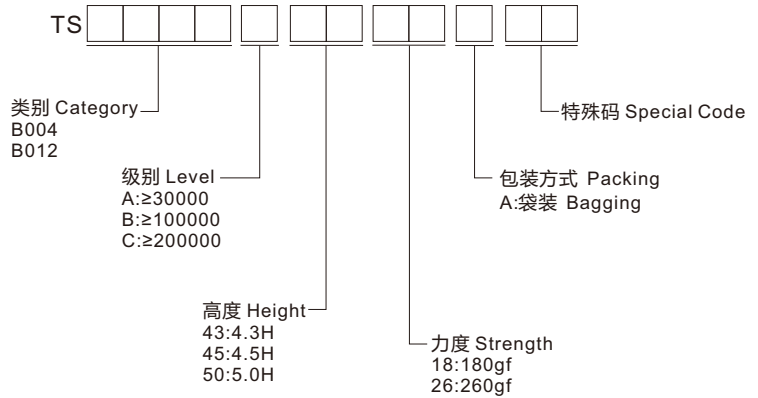

## ◆ 规格 Specifications

- 使用温度 Operating temperature : -20°C~+80°C
- 最大额定值 Maximum rating : 50mA 12V DC
- 最小额定值 Minimum rating : 10μA 1V DC
- 接触电阻 Contact resistance : ≤100mΩ
- 绝缘电阻 Insulation resistance : ≥100MΩ
- 耐电压 Withstand voltage : 250V AC

## ◆ 材质 Material

- 接触点 Contact point : 铜合金 Copper alloy
- 本体 Ontology : PPA/LCP
- 弹片 Shrapnel : 不锈钢 Stainless steel
- 盖板 Cover : 铁/铜合金 Iron/copper alloy
- 按钮 Button : PPA/LCP

## ◆ 图表 Diagram

### ■ TS-B004

L	H
3.35	4.3
3.85	4.8
4.05	5.0
4.35	5.3
4.55	5.5

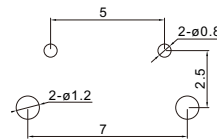
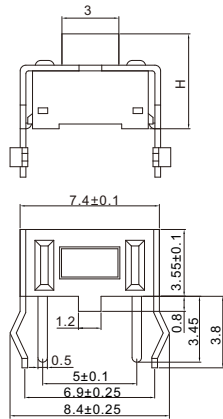
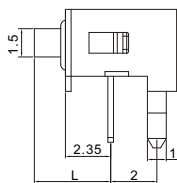

安装图  
instructions



电路图  
Circuit diagram

### ■ TS-B012

H
4.3
4.5
4.8
5.0
5.3
5.5
6.0
7.0

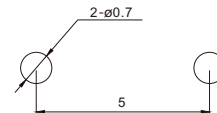
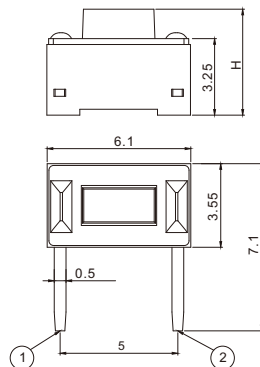
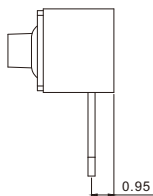

安装图  
instructions

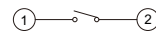

电路图  
Circuit diagram